

# COOKTOPS

# Induction 600mm

## CI6SE2

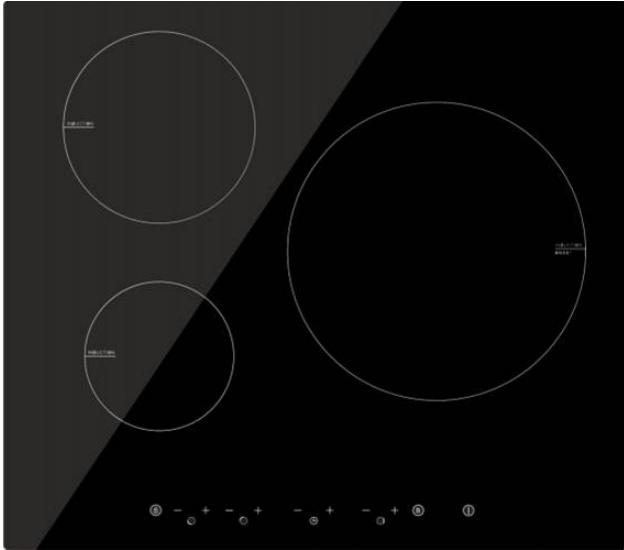

- 3 cooking zones with BOOSTERS
- Ceramic glass cooking surface
- Front Touch Controls with RED display
- 9 power settings for each zone
- 99 minute timer
- Child lock
- Overflow protection
- Residual heat indicators

features

### specifications

<b>Cooking zones:</b>	Front Left - 140mm, 1200W (Booster -1500W) Rear Left - 180mm, 2300W (Booster -2600W) Centre Right - 280mm, 3000W (Booster -4000W)
<b>Kilowatt rating:</b>	7.2 kW (30amp, hardwired)
<b>Power:</b>	220-240 volt / 50Hz
<b>Weight:</b>	Net - 9.5kg, Gross - 11.5kg

### IMPORTANT INSTALLATION NOTE

When installing Electric / Induction cooktops above a cupboard opening or set of drawer drawers a heat shield is required

Induction cooktops will also require a heat barrier in the middle to ensure less transfer of heat from front to back of cooktop

*Refer to our website for DETAILS*

### dimensions

**Product Dimensions** 590mm (L) x 520mm (B) x 56mm (D)

**Cut Out Dimensions** 560mm (L) x 490mm (B)

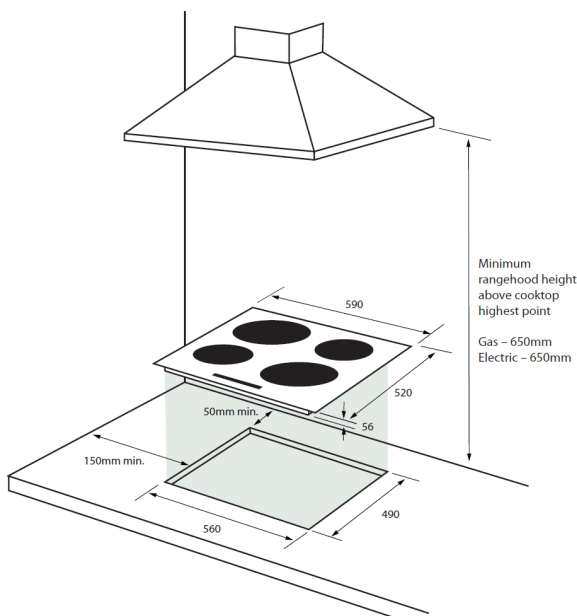

warranty - customer service

#### Warranty

2 years Parts and Labour

#### Customer Service

Our Nationwide Service Team can be contacted on our Toll Free Customer Service Number 1800 805 300 or by logging on to <http://customersupport.hapl.com.au/>

Home Appliances  
20 Carlotta Street  
Artarmon NSW 2064  
T: 02 9958 3111  
F: 02 9958 3555  
E: info@hapl.com.au

[www.hapl.com.au](http://www.hapl.com.au)

# COOKTOPS

## Induction 600mm

### CI6SE2

#### INDUCTION COOKTOP INSTALLATION REQUIREMENTS

Induction cook tops heat rapidly and unlike other cook tops require separated air intake and air exhaust outlets.

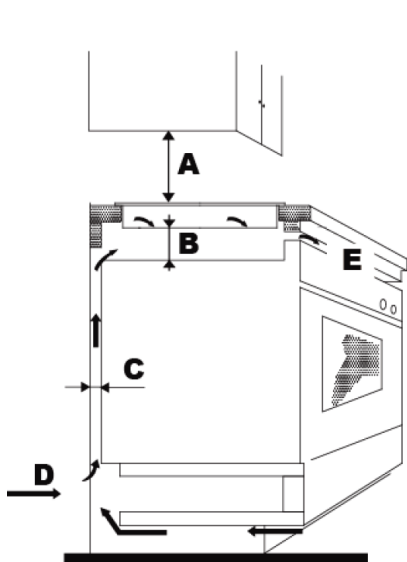
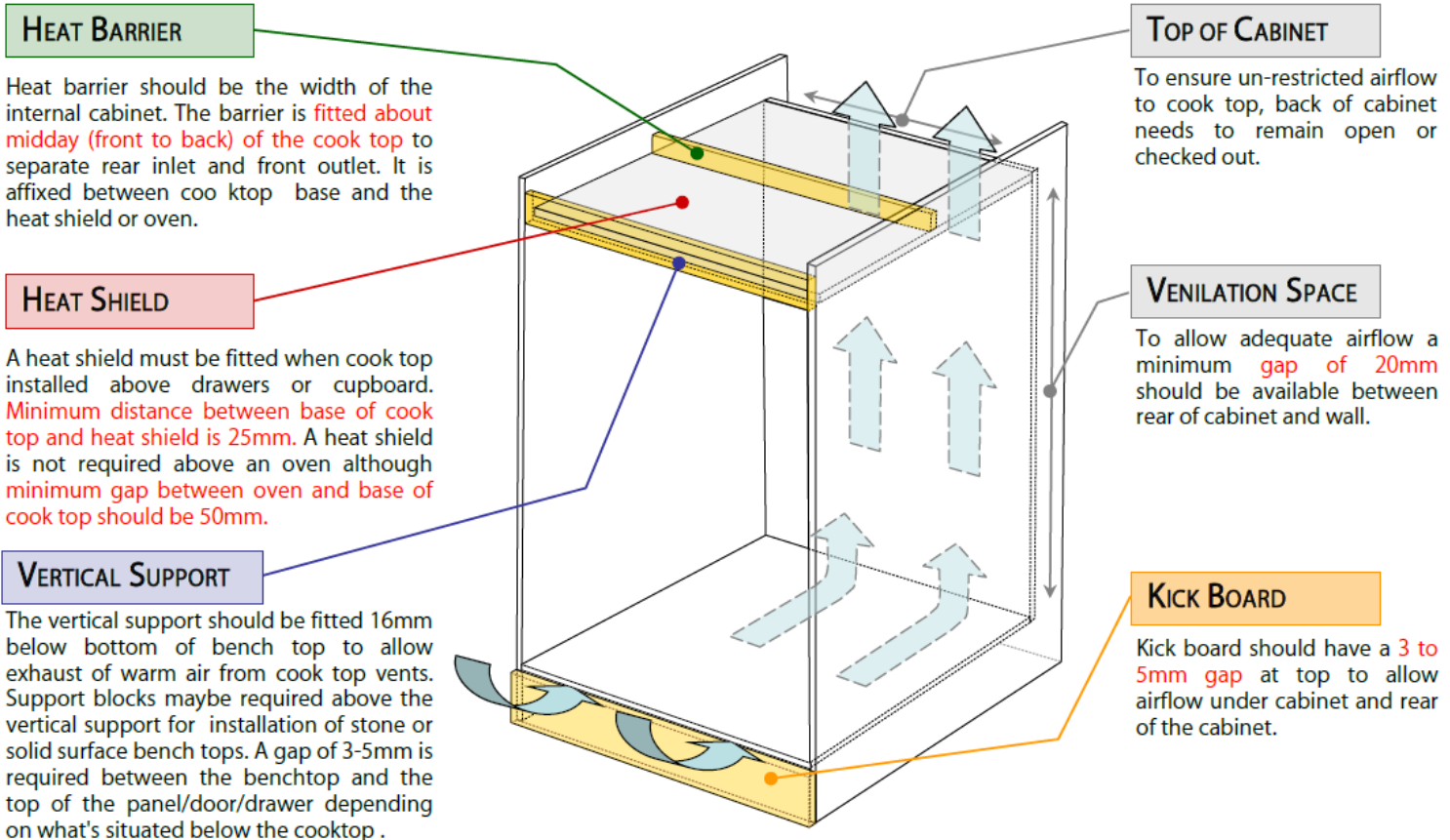

A(mm)	B(mm)	C(mm)	D	E
760	50 mini	20 mini	Air intake	Air exit 5mm

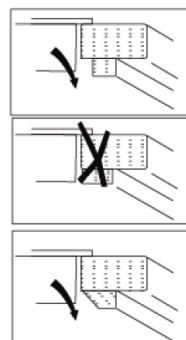

#### Warranty

2 years Parts and Labour

#### Customer Service

Our Nationwide Service Team can be contacted on our Toll Free Customer Service Number 1800 805 300 or by logging on to <http://customersupport.hapl.com.au/>

Home Appliances  
20 Carlotta Street  
Artarmon NSW 2064  
T: 02 9958 3111  
F: 02 9958 3555  
E: info@hapl.com.au

[www.hapl.com.au](http://www.hapl.com.au)